



INSTRUCTION MANUAL

MARLEY WIRELESS SOUND BAR



Important Safety Instructions

 **WARNING:** To reduce the risk of electric shock, do not dismantle the product and do not expose the product to rain or moisture. No user-serviceable parts inside. Refer servicing to qualified personnel only.

1. Read the user manual before use. Keep all instructions for future reference
2. Always operate the product from a power source of the same voltage, frequency and rating as indicated on the rating label.
3. This product is intended for indoor, household use only.
4. To protect against electric shock: do not immerse unit, plug or cord in water or spray with liquids; do not place unit on windowsills or other places where it may be exposed to dripping or splashing of water; do not place vases or similar objects filled with liquids near the unit.
5. Do not use this product in the immediate vicinity of water such as bathtubs, washbowls, swimming pools etc. where the likelihood of immersion or splashing occur.
6. Keep the unit away from heat sources like radiators, heat registers, stoves or other products that produce heat. No open flame sources like candles should be placed on the unit.
7. Use only with attachments/accessories specified by the manufacturer. Use of attachments/accessories not recommended can be hazardous.
8. This appliance is not intended for use by persons (including children) with reduced physical, sensory or mental capabilities, or lack of experience and knowledge, unless they have been given supervision or instruction concerning use of the appliance by a person responsible for their safety.
9. This product is not a toy! Children should be supervised to ensure that they do not play with the appliance.
10. Do not cover the unit during use. Do not impede ventilation by covering ventilation openings with cloths, curtains or similar items.
11. Do not operate the product with a damaged cord or plug or if the product malfunctions, or is dropped or damaged in any manner.
12. If the supply cord is damaged, it must be replaced by the manufacturer, its service agent or similarly qualified persons in order to avoid hazard.
13. For safety reasons, do not remove any covers or attempt to access the inside of the product.
14. Do not clean the unit with any harsh chemicals as this might damage the finish. Wipe clean with a dry cloth.
15. When removing the power plug from the wall outlet, always pull directly on the plug; never pull on the cord.
16. Do not expose the batteries to excessive heat, direct sunlight, fire or similar.
17. Do not throw used batteries in your household rubbish. Dispose of it responsibly according to local regulations.

Remote Control Description

Using the remote control:

1. POWER

Press this button to power on or power off.

2. MODE

Press this button to switch the mode within Bluetooth, USB, Aux-in, HD-in (ARC-in) and Optical-in.

3. VOL+

Press VOL+ to up the volume of the soundbar

4. ⏮

Under Bluetooth and USB mode, press this button will go to previous song.

5. MOVIE

Press this button will enter MOVIE mode sound effect.

6. TREB

Press this key and then press the volume up or down key to adjust the high sound effect.

7. RESET

Press this button will resume the factory sound setting.

8. MUTE

Short press this key briefly to turn the sound off or on.

9. ▶|| / PAIR

Press to play/pause music
Long press and hold this key to disconnect Bluetooth or Bluetooth pairing.

10. ▶▶

Under Bluetooth and USB mode, press this button will go to next song.

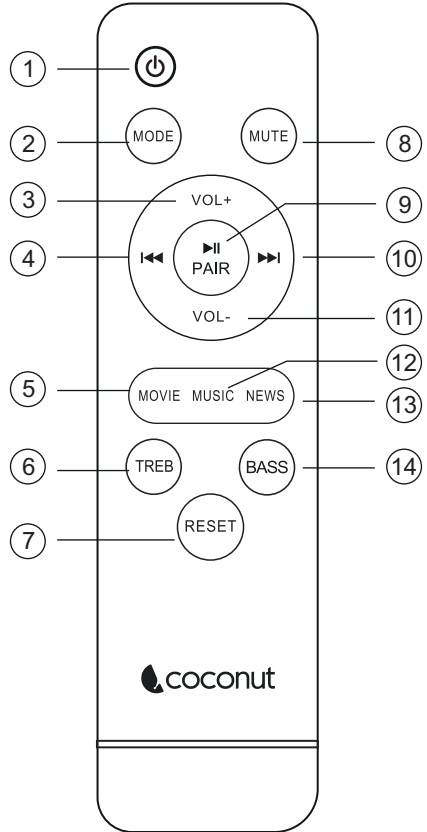

11. VOL-

press VOL- to down it.

12. MUSIC

Press this button will enter MUSIC mode sound effect.

13. NEWS

Press this button will enter NEWS mode sound effect.

14. BASS

Press this key and then press the volume up or down key to adjust the bass sound.

Front/Back panels

FRONT



1. POWER

Long press this button to power on or power off
Short press this button to change mode.



2. ▶||

when playing music, press this button to pause playing, and repress to play continue.
Long press this button to pair soundbar and subwoofer.

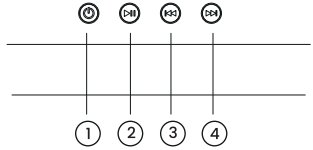

3. ◀◀

Under Bluetooth and USB mode,
press this button will go to previous song.

4. ▶▶

Under Bluetooth and USB mode, press this
button will go to next song.

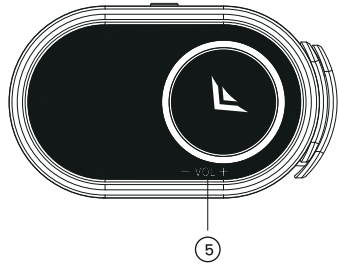

5. -VOL+

Adjust the volume knob.

BACK

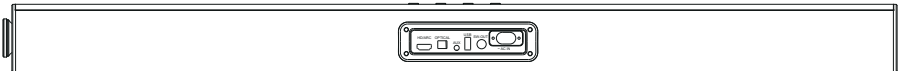

1. HD/ARC
2. OPTICAL
3. AUX
4. USB
5. SW-OU
6. ~AC IN

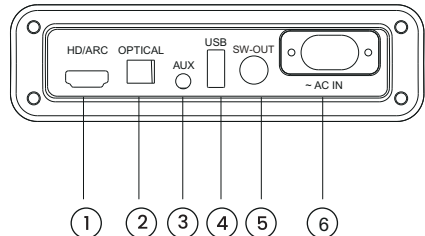

Connection schematic

CONNECTING THE SOUNDBAR TO TV

1. Subwoofer
2. Connection to TV: HD Input on the sound bar to HD(ARC) Output on TV

Note: Alternatively, you can use the AUX cable (included) to connect the 'AUX-IN' port on the sound bar to the Auxiliary out or the Headphone jack on the TV.

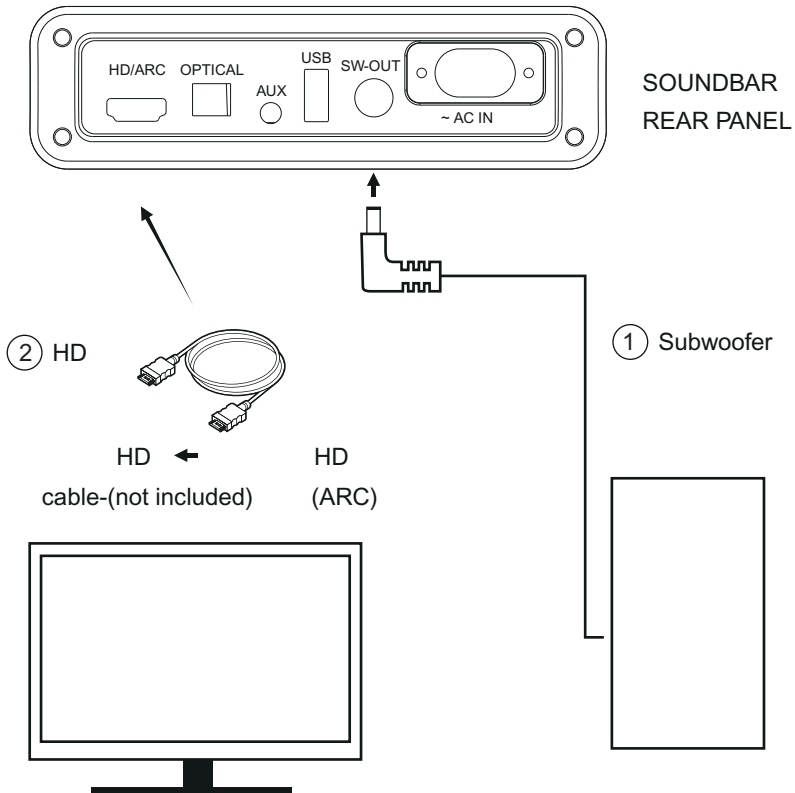

CONNECTING THE SOUNDBAR TO OTHER DEVICES

3. OPTICAL input on the sound bar to OPTICAL Output of other devices(Blu-ray/ DVD player/Gaming consoles).

4. Other audio sources:Blue-connect/AUX-IN.

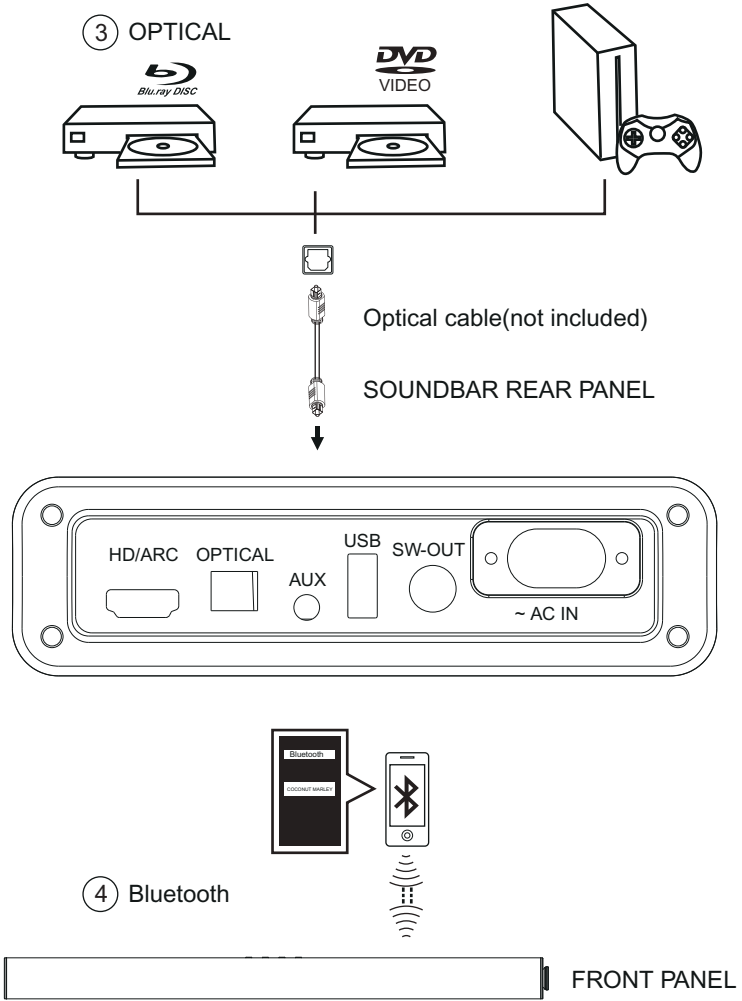

Operating Instructions:

With Ac power connected to the Speaker, the display glows with prompt voice , which means that successfully power on. Long press the Power/Mode button on the side panel or the Mode key on the remote control to choose the required mode.

Blue-Connect Mode:

1. Press the 'MODE' button repeatedly until Blue-Connect Mode is selected. Display shows 'BT'
2. On your Bluetooth-enabled device choose ' COCOUNT MARLEY ', the name of the sound bar. The display blinks indicating that it is waiting for pairing, once pairing is successful, the indicator remains on, display shows 'BT' and stop flashing.
3. Now you can play music from your Bluetooth-enabled device on the sound bar. Press the ◀◀ or ▶▶ button on the remote control to play the previous or next song.

Aux Input

If using the Aux cable connect the Speaker to audio equipment, select 'AUX' by using the Mode key on the remote control or the Power/Mode key on the side panel. 'AUX' will be displayed on the display accompanied by 'AUX' prompt.

HD/ARC Input

If using HD/ARC cable connect Speaker to audio equipment, through the mode button on the remote control or the Power/Mode key on the side plate to select 'ARC', screen displays 'ARC' accompanied by 'ARC' prompt.

OPTICAL Input

If using OPTICAL cable to connect speaker, through the mode button on the remote control or the Power/Mode key on the side plate to select 'OPT', screen displays 'OPT' accompanied by 'OPT' prompt.

Connection schematic

RECOMMENDED PLACEMENT

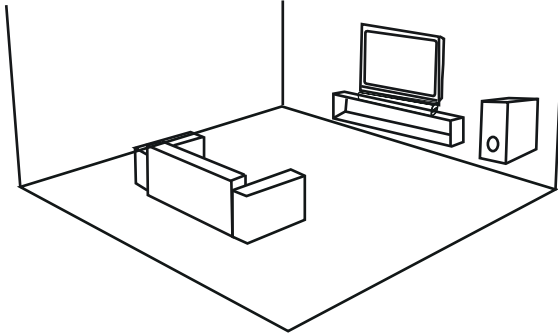

Soundbar: Under the TV(if wall-mounted)/in front of the TV

Subwoofer: on the floor, alongside the TV(or in the front corner of the room)

Speaker Specification

Soundbar Rated Power	45W+45W
Subwoofer Rated Power	90W
Input Voltage	AC 110~240V 50/60Hz
Input signal source	Optical,AUX terminal,Bluetooth,HD/ARC
Dimensions for sound bar	960*118*73mm
Dimensions for subwoofer	200*326*380mm
ACCESSORIES:	Remote control, Audio line, mountable screws, manual

Brief on general scheme of collection:

We have partnered with M/s Aseries Envirotek India Pvt. Ltd. registered with Uttar Pradesh Pollution Control Board for management and dismantling/ recycling of all our e-waste.

- As a part of agreement, M/s Aseries Envirotek India Pvt. Ltd. will collect all our E-waste generated from PAN India and dismantle the same at their plant at Plot No. B-10, Industrial Area, Salon, Raebareli (UP) – 229127.
- M/s Aseries Envirotek India Pvt. Ltd., our e-waste management partner is having all authorization related e-waste dismantling from UPPCB and having all connects related to Air/Water/Hazardous waste. They have capacity of 840 MT per annum.
- Keeping in view our sales volume and generation of e-waste as per our future e-waste targets and our expansion plan we have decided to follow these mechanisms in our organization for collection of e-waste.
- As per our agreement with M/s Aseries Envirotek India Pvt. Ltd. if any customer wants to handover their old product they can call our e-waste dismantler's Toll Free No 1800 120 2626 00 (on behalf of M/s Heera Communications). The representative will explain about the process of disposal and will aware about nearest drop point available and also give information about incentive we will offer to them against their end of life product. If any customer wants to handover the material from their door steps we do send either logistics team or Aseries Envirotek India Pvt. Ltd. team to collect the items and channelize the same to our e-waste partner plant for final processing.
- M/s Aseries Envirotek India Pvt. Ltd. has signed an agreement with Professional Logistics Pvt. Ltd. for reverse logistics.
- M/s Aseries Envirotek India Pvt. Ltd. has signed an agreement with Rajdhani Recycling Private Limited for Recycling of dismantled e-waste.

Benefit of recycling of E-waste:

- E-waste contains many valuable, recoverable materials such as aluminum, copper, gold, silver, plastics, and ferrous metals. In order to conserve natural resources and the energy needed to produce new electronic equipment from virgin resources, electronic equipment can be refurbished, reused, and recycled instead of being landfilled.

- Protects your surroundings- Safe recycling of outdated electronics promotes sound management of toxic chemicals such as lead and mercury.
- Conserves natural resources- Recycling recovers valuable materials from old electronics that can be used to make new products. As a result, we save energy , reduce pollution, reduce greenhouse gas emissions, and save resources by extracting fewer raw materials from the earth.
- Helps others - Donating your used electronics benefits your community by passing on ready-to-use or refurbished equipment to those who need it.
- Saves landfill space - E-waste is a growing waste stream. By recycling these items, landfill space is conserved.

Dismantling/Recycling of E-waste:

M/s Aseries Envirotek India Pvt. Ltd. will collect E-waste and dismantle the same at their Plot No. B-10, Industrial Area, Salon, Raebareli (UP) – 229127.

Do's &Dont's

Do's:

- Always look for information on the catalogue with your product for end-of-life equipment handling.
- Ensure that only Authorized Recyclers repair and handle your electronic products.
- Always call our E-waste Authorized Collection Centres/points to dispose products that have reached end-of life.
- Always drop your used electronic products, batteries or any accessories when they reach the end of their life at your nearest Authorized E-Waste Collection Centres/Points.
- Always disconnect the battery from product, and ensure any glass surface is protected against breakage.

Don'ts:

- Do not dismantle your electronic Products on your own
- Do not throw electronics in bins having “Do not Dispose” sign.
- Do not give e-waste to informal (Kabbadi) and unorganized sectors like Local Scrap Dealer/ Rag Pickers.
- Do not dispose your product in garbage bins along with municipal waste that ultimately reaches landfills.

For any Support or Assistance

Toll Free : 1800-843-1214

Email : support@coconutlife.in



